

Get data directly from outdoor sensors—no console required!

Weather Envoy™

Weather Envoy, when used along with WeatherLink, will collect and store data from the outdoor sensors. Download to your computer at your convenience, then use the WeatherLink software to view current conditions, graph and chart historical data, or even create your own weather web pages. Weather Envoy includes its own barometer and inside temperature and humidity sensors. Both the wireless and cabled versions include an AC-power adapter. Either may also be run using one of our solar power kits. The wireless model can also run on three AAA batteries. Expected battery life is four to six months, depending on the logging interval. Batteries should also be added to the cabled model for backup during power outages.

(Requires WeatherLink data logger and software package, not included. See pages 15–17.)

6316 Wireless Weather Envoy

6316C Cabled Weather Envoy



Envoy shown with WeatherLink data logger installed.

Typical Weather Envoy Installations

WIRELESS WEATHER ENVOY INSTALLATION

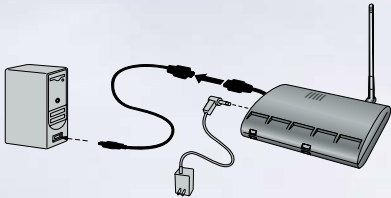

Install wireless or cabled Weather Envoy next to your computer using included USB cable and AC adapter for easy and convenient downloading without a console/receiver.

Use Weather Envoy instead of, or in addition to, a Vantage Pro2 or Vantage Vue console/receiver.

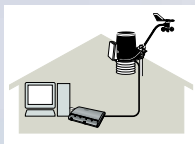

Cabled Home/Office Station

WEATHER ENVOY IN A CABLED FIELD STATION INSTALLATION

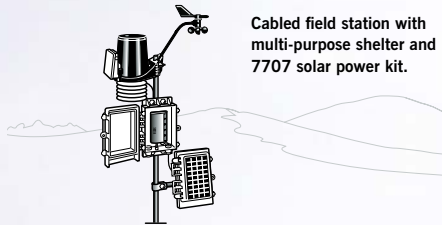

Cabled field station with multi-purpose shelter and 7707 solar power kit.

A cabled Weather Envoy can be used with ONE of the following:

- Cabled Integrated Sensor Suite (ISS)
- Cabled ISS Plus

WEATHER ENVOY IN A WIRELESS FIELD STATION INSTALLATION



Runs on batteries or Solar Power Kit.

A wireless Weather Envoy can be used with ALL of the following:

- One Wireless ISS or ISS Plus
- One Anemometer Transmitter Kit
- One Wireless Leaf & Soil Moisture/Temperature Station
- Three Temperature Stations or one Temperature Station and two Temperature/Humidity Stations

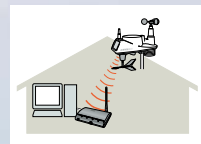

Wireless Home/Office Station



Transmit simultaneously to both Envoy and console.



Retransmit data to Weather Envoy from console



Retransmit from Weather Envoy to console

INTEGRATED SENSOR SUITES

Vantage Vue Integrated Sensor Suite

Because Vantage Vue's transmitters are radio-compatible with Vantage Pro2, you can mix and match components. Can transmit to Vantage Vue, wireless Vantage Pro2 consoles, or wireless Weather Envoy. Mounting pole not included.

6357 Vantage Vue Integrated Sensor Suite



Both Vantage Vue and Vantage Pro2 ISS can be used with Weather Envoy and WeatherLink (see page 15).

Vantage Pro2 Integrated Sensor Suite

For use with Weather Envoy and WeatherLink. Includes all the features of the Vantage Pro2 and Pro2 Plus integrated sensor suites shown on page 6. Can transmit to Vantage Vue and Vantage Pro2 consoles, and Weather Envoy. Mounting pole not included.

Wireless Integrated Sensor Suite

- 6322 with Standard Radiation Shield
- 6323 with 24-Hour Fan-Aspirated Radiation Shield

Cabled Integrated Sensor Suite*

- 6322C with Standard Radiation Shield

Wireless Integrated Sensor Suite Plus with UV and solar radiation sensors

- 6327 with Standard Radiation Shield
- 6328 with 24-Hour Fan-Aspirated Radiation Shield

Cabled Integrated Sensor Suite Plus with UV and solar radiation sensors*

- 6327C with Standard Radiation Shield



* Can only be used with a cabled Vantage Pro2 console/receiver

